

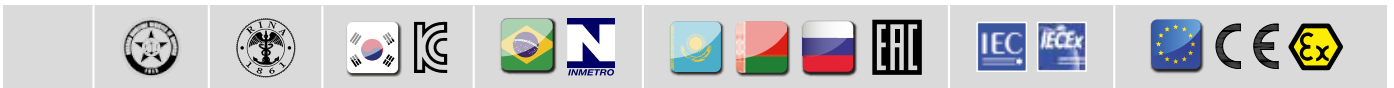

PNA Cable glands for unarmoured cables

Installation: hazardous areas - Zone 1 / 2 (Gases) - Zone 21 / 22 (Dusts)

Classification: Group II - Category 2G 2D



REFERENCE STANDARDS

Directive 94/9/EC (until April 19th, 2016) and Directive 2014/34/EU (from April 20th, 2016)

EXECUTION	⊕ II 2 G Ex d / Exe / Exia IIC Gb ⊕ II 2 D Ex tb IIIC Db
RULES OF COMPLIANCE	EN/IEC 60079-0; EN/IEC 60079-1; EN/IEC 60079-7; EN/IEC 60079-31
EC Type-Examination Certificate	INERIS 09 ATEX 0028X
PROTECTION DEGREE	IP66 or IP66/68
AMBIENT TEMPERATURE	-40°C ÷ +90°C (Rubber rings EPDM-60) -60°C ÷ +180°C (Rubber rings SILICON)
OTHER AVAILABLE CERTIFICATES	IECEx: IECEx INE 13.0017X INMETRO: CEPEL 12.2175X EAC: TC RU C-IT.Г508.B 01624 (-75°C ÷ +180°C) RINA: ELE18111CS_016 RUSSIAN MARINE CERTIFICATE (RMRS): 13.03518.315 Kc (Korean certification):14-KB4B0-0455X

Mechanical characteristics

Body / cap	OT-58 marine brass (ON) - AISI-316L stainless steel (IX)
Finishes	full nickel plating treatment (brass material only)
Rubber rings	EPDM rubber- 50-60 shore hardness - Silicon rubber - 60 shore hardness
O-ring	silicon rubber - 60 shore hardness
Skid washer	nylon 6.0
Chamber for sealing	OT-58 marine brass ("R" version only)

Applications

- For unarmoured cables only
- Single compression type suitable for indoor and outdoor use
- Single compression - on cable (inner sealing)
- Sealing with proper resin into "chamber of sealing" (on barrier type version "R" only)

On Request Accessories:

- Locknuts, Gaskets, PVC Shrouds, Earthing Tags, Sealing (See DL-NW-PTD-ET bulletin)



PNA Cable gland selection table

CODE	SIZE	ENTRY THREAD SIZE				INNER SHEATH DIA.		HEXAGON [mm]	MATERIAL			
		METRIC (2)	NPT (2)	UNI ISO 228 (2)	min [mm]	max [mm]	(3)					
PNA# PNA-R#	00*	ISO-M20	M	1/2"NPT	N	1/2"	G	4,0	7,0	24,0	NICKEL PL.BRASS	ON
								7,0	10,0		STAINLESS STEEL	IX
PNA# PNA-R#	01	ISO-M20	M	1/2"NPT	N	1/2"	G	5,5	8,0	32,0	NICKEL PL.BRASS	ON
								8,0	10,5		STAINLESS STEEL	IX
								10,5	13,0			
PNA# PNA-R#	02	ISO-M25	M	3/4"NPT	N	3/4"	G	10,5	13,0	36,0	NICKEL PL.BRASS	ON
								13,0	15,5		STAINLESS STEEL	IX
								15,5	18,0			
PNA# PNA-R#	03	ISO-M32	M	1"NPT	N	1"	G	15,0	18,0	45,0	NICKEL PL.BRASS	ON
								18,0	21,0		STAINLESS STEEL	IX
								21,0	24,0			
PNA# PNA-R#	04	ISO-M40	M	1 1/4"NPT	N	1 1/4"	G	21,0	24,0	53,0	NICKEL PL.BRASS	ON
								24,0	27,0		STAINLESS STEEL	IX
								27,0	30,0			
PNA# PNA-R#	05	ISO-M50	M	1 1/2"NPT	N	1 1/2"	G	24,0	27,0	61,0	NICKEL PL.BRASS	ON
								27,0	30,0		STAINLESS STEEL	IX
								30,0	33,0			
								33,0	36,0			
PNA# PNA-R#	06	ISO-M63	M	2"NPT	N	2"	G	36,0	39,0	71,0	NICKEL PL.BRASS	ON
								39,0	42,0		STAINLESS STEEL	IX
								42,0	45,0			
PNA# PNA-R#	07	ISO-M75	M	2 1/2"NPT	N	2 1/2"	G	42,0	45,0	84,0	NICKEL PL.BRASS	ON
								45,0	48,0		STAINLESS STEEL	IX
								48,0	51,0			
								51,0	54,0			
PNA# PNA-R#	08	ISO-M90	M	3"NPT	N	3"	G	52,0	56,0	101,0	NICKEL PL.BRASS	ON
								56,0	59,0		STAINLESS STEEL	IX
								59,0	62,0			
								62,0	65,0			
								65,0	68,0			
PNA# PNA-R#	09	ISO-M100	M	4"NPT	N	4"	G	68,0	74,0	126,0	NICKEL PL.BRASS	ON
								74,0	80,0		STAINLESS STEEL	IX
								80,0	86,0			
								86,0	92,0			

CABLE GLAND ORDERING
EXAMPLES

PNA#	01	M	ON	= PNA#01MON (NON-BARRIER CABLE GLAND NICKEL PLATED BRASS ISO-M20 THR.)
PNA#	03	N	IX	= PNA#03NIX (NON-BARRIER CABLE GLAND STAINLESS STEEL 1/2"NPT THR.)

*NOTE: 00 SIZE WITH ISO-M16 OR 3/8"NPT - 3/8"ISO-228 BODY, ON REQUEST

LEGEND

(1)	CABLE GLAND TYPE/MODEL	PNA# = NON-BARRIER CABLE GLAND - PNA-R# = BARRIER CABLE GLAND
(2)	THREADING	M = ISO METRIC pitch 1,5mm - N = NPT (ANSI/ASME B1.20.1) - G = UNI ISO-228
(3)	CABLE GLAND MATERIAL	ON = NICKEL PLATED MARINE BRASS - IX = AISI-316L STAINLESS STEEL

PNA DIMENSIONAL

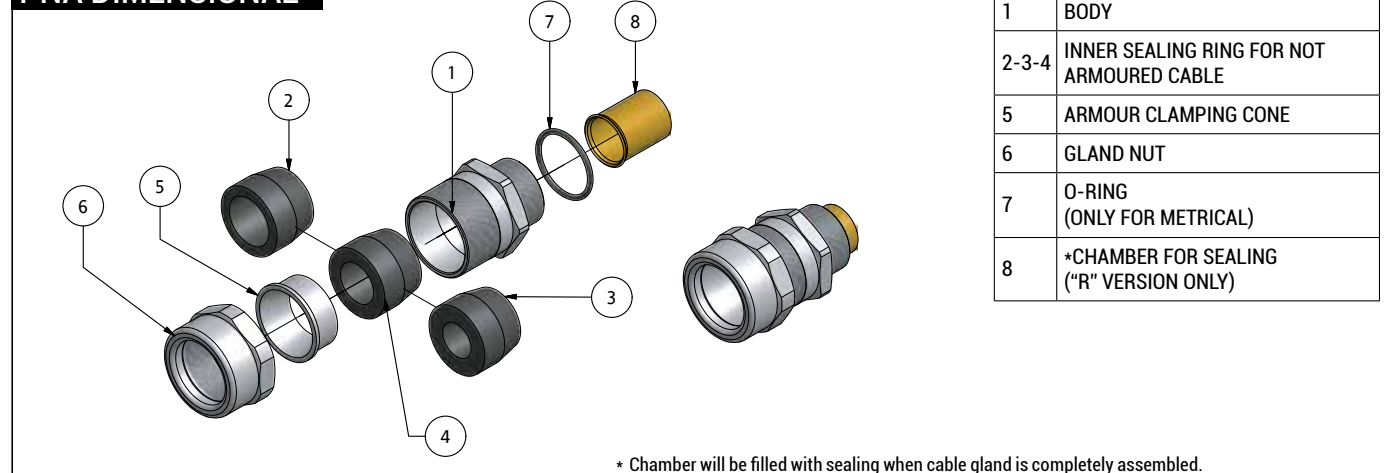

REMARK:

Due to the development of the national and international specifications and of the technology, the above technical characteristics showed on this bulletin can be considered as binding on our confirmation only.