

# EFSC

## Rotary switches and selector switches

**Installation:** hazardous areas - Zone 1 / 2 (Gases) - Zone 21 / 22 (Dusts)

**Classification:** Group II - Category 2G 2D

Explosion Proof Electrical Equipment



Ex Control station

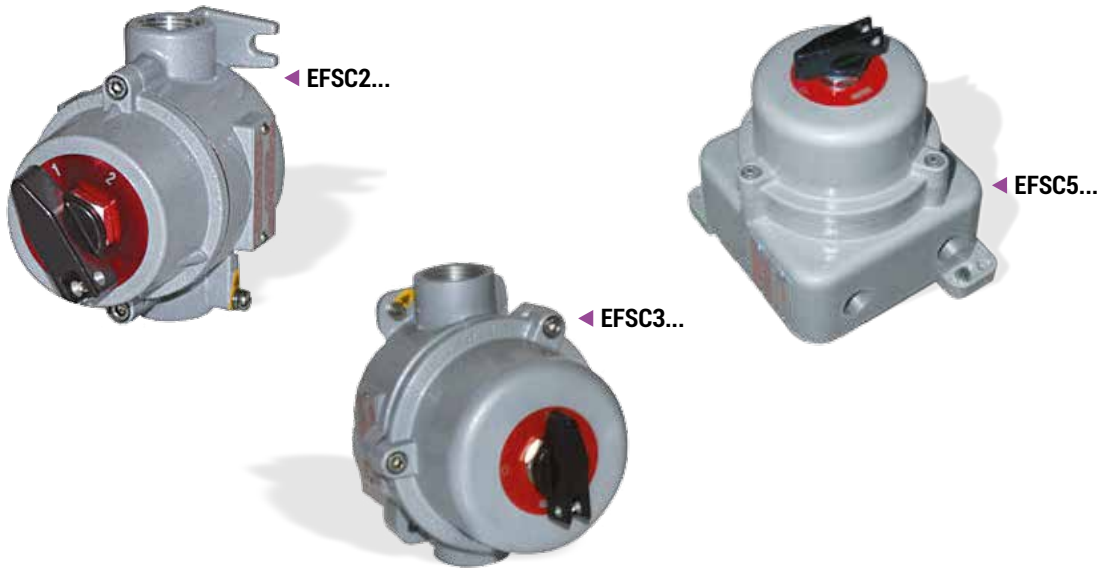

EFSC

www.feam-ex.com

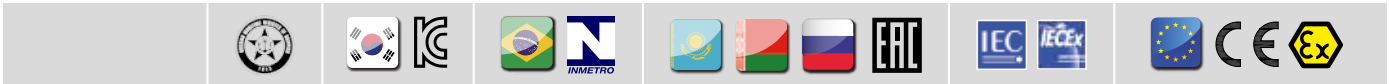

### REFERENCE STANDARDS

**Directive 94/9/EC (until April 19th, 2016) and Directive 2014/34/EU (from April 20th, 2016)**

EXECUTION	⊗ II 2 G Ex d IIC T6/T5 Gb ⊗ II 2 D Ex tb IIIC T85°C/T100°C Db
RULES OF COMPLIANCE	EN/IEC 60079-0; EN/IEC 60079-1; EN/IEC 60079-31
EC Type-Examination Certificate	INERIS 04 ATEX 0076X
PROTECTION DEGREE	IP66
AMBIENT TEMPERATURE	-60°C ÷ +60°C
OTHER AVAILABLE CERTIFICATES	IECEx: IECEx INE 11.0033X INMETRO: CEPPEL 13.2255X EAC: TC RU C-IT.ГБ08.B.01323 RUSSIAN MARINE CERTIFICATE (RMRS): 13.03520.315 Kc (Korean Certification): 14-KB4B0-0472

### Mechanical characteristics

Body	marine grade copper free aluminium light alloy
Cover	marine grade copper free aluminium light alloy
Screws	stainless steel
Gasket	NBR rubber sealing ring

### On request accessories:

- External epoxy painting with colour on request
- Different threads from standard

# EFSC

## Technical Features



www.feam-ex.com

CODE	A [mm]	B [mm]	C [mm]	D [mm]	ØE [mm]	TEMPERATURE CLASS (GAS)	TEMPERATURE CLASS (DUSTS)	WEIGHT [Kg]	DETAIL
EFSC2...	120	135	95	55	GK 3/4"	T6 / T5	T85°C / T100°C	0,90	A
EFSC3...	140	150	100	80	GK 1"	T6 / T5	T85°C / T100°C	0,90	B
EFSC5...	165	170	150	115	-	T6 / T5	T85°C / T100°C	1,80	C

CODE ON/OFF SWITCHES 500V 50/60Hz				RATE [In]	DETAIL
1 POLE	2 POLES	3 POLES	4 POLES		
EFSC21	EFSC22	EFSC23	-	16A	A
EFSC3125	EFSC3225	EFSC3325	EFSC3425	25A	B
EFSC5125	EFSC5225	EFSC5325	EFSC5425	25A	C
EFSC3132	EFSC3232	EFSC3332	EFSC3432	32A	B
EFSC5132	EFSC5232	EFSC5332	EFSC5432	32A	C

CODE TWO WAY SWITCHES 500V 50/60Hz				RATE [In]	DETAIL
1 POLE	2 POLES	3 POLES	4 POLES		
EFSC21D	EFSC22D	-	-	16A	A
EFSC3125D	EFSC3225D	EFSC3325D	(1)	25A	B
EFSC5125D	EFSC5225D	EFSC5325D	(1)	25A	C
EFSC3132D	EFSC3232D	EFSC3332D	(1)	32A	B
EFSC5132D	EFSC5232D	EFSC5332D	(1)	32A	C

(1): On request only

CODE CHANGE OVER SWITCHES 500V 50/60Hz				RATE [In]	DETAIL
1 POLE	2 POLES	3 POLES	4 POLES		
EFSC21C	EFSC22C	-	-	16A	A
EFSC3125C	EFSC3225C	EFSC3325C	(1)	25A	B
EFSC5125C	EFSC5225C	EFSC5325C	(1)	25A	C
EFSC3132C	EFSC3232C	EFSC3332C	(1)	32A	B
EFSC5132C	EFSC5232C	EFSC5332C	(1)	32A	C

(1): On request only

SELECTOR SWITCHES 500V 50/60Hz				DIAGRAM	DETAIL
CODE	RATE [In]	CODE	RATE [In]		
EFSC310R	10A	EFSC316R	16A	R	B
EFSC310X	10A	EFSC316X	16A	X	B
EFSC310Y	10A	EFSC316Y	16A	Y	B
EFSC310W	10A	EFSC316W	16A	W	B
EFSC310Z	10A	EFSC316Z	16A	Z	B
EFSC510R	10A	EFSC516R	16A	R	C
EFSC510X	10A	EFSC516X	16A	X	C
EFSC510Y	10A	EFSC516Y	16A	Y	C
EFSC510W	10A	EFSC516W	16A	W	C
EFSC510Z	10A	EFSC516Z	16A	Z	C

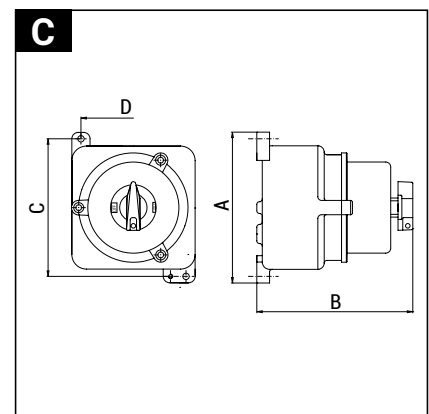
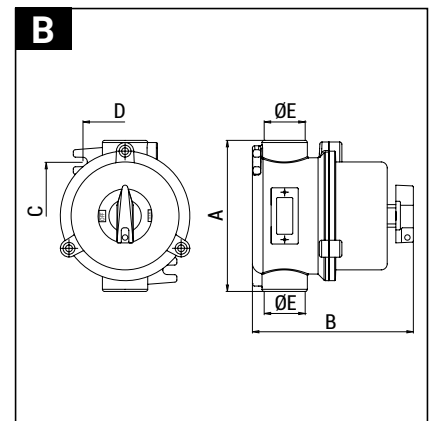
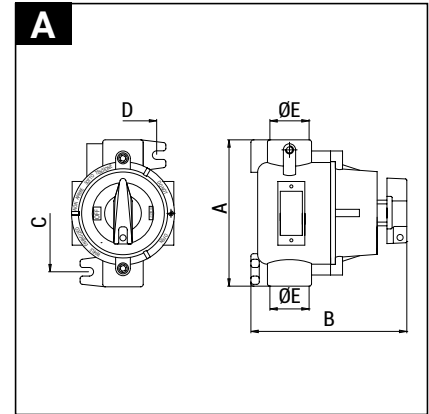

## EFSC Motor switch diagram arrangements

TYPE "R" Contactor control with maintained OFF position	TYPE "X" Contactor control	TYPE "Y" Reverse motor starter control	TYPE "W" Impulse control	TYPE "Z" MAN. AUT. control

\*DIAGRAM ARRANGEMENTS DIFFERENT THAN STANDARD, PLEASE CONTACT OUR SALES DEPT.

REMARK:

Due to the development of the national and international specifications and of the technology, the above technical characteristics showed on this bulletin can be considered as binding on our confirmation only.