



DESCRIPTION

The emergency fluorescent light fitting type PSF E is intended for use in places with an explosive gas and dust atmosphere. The light fitting is designed for use in the industrial areas and facilities, indoor and outdoor spaces.

Hazardous zones: 1,2, 21, 22.

Ex fluorescent light fitting type PSF E is used as emergency light fitting with >1,5h autonomy.

CONSTRUCTION

Housing: SMC polyester plastic reinforced with glass fiber, color RAL 7038

Diffuser: PC polycarbonate plastic

Gasket: EPDM formed gasket

Central locking: can be opened/closed using a socket key SW8, hinged lamp cover

The light fitting is normally supplied without light sources, with socket key, two Ex e cable glands M25, two Ex e plugs M25 and with four ring screw M8 (pendant version).

TECHNICAL DATA

Certificate:	ATEX
Marking:	C € 0722
Apparatus category:	II 2GD
Explosion protection:	Ex d e mb IIC T4 Gb Ex tb IIIC T80°C Db
Ambient temperature:	-5°C ≤ T _a ≤ +40°C
Degree of protection:	IP 66 category 1
Resistance to shock:	IK 08
Protection class:	I (procreative earthing)
Rated voltage:	220....240 V (±10%)
Frequency:	50/60 Hz
Power factor:	λ=0,95
Ballast lumen factor BLF:	97,4%
Battery:	Ni-Cd 6V/4Ah (7Ah)
Nominal autonomy:	1,5 h
Estimated service life:	70 000 h at T _{amb} =40°C
Terminals:	L1, L2, L3, N, PE - max. 2,5 mm ²
Cable entries:	2 x cable glands Ex e M25x1,5, for cable Ø8-17 mm, 2 x plugs Ex e
Disconnection of the light:	Switch with safety lock; when opening the central lock, all poles of the voltage supply to the ballast are disconnected; contacts of the switching element are NC contacts, they can only be switched on again when the lamp cover and the central locking system are closed. In case of a lamp fault, the electronic ballast disconnects the defective lamp from the power supply.
Piktogram:	300x150mm
Packing:	The packing contains: 1 pcs PSF 236 E : 1420x270x210 mm PSF 218 E : 825x270x210 mm

PSF E

MODEL CODE

TYPE	WATTAGE	LAMP TYPE	NOMINAL VOLTAGE	LUMINOUS FLUX [lm]	LUMINOUS FLUX bat. mod [lm]	LAMP HOLDER	NOMINAL OPERATIONAL CURRENT	WEIGHT
PSF 218 E	2 x 18 W	T8	220-240 V	2 x 1350	1 x 540 (ca 40%)	G13	0,18 A	9,0 kg
PSF 236 E	2 x 36 W			2 x 3350	1 x 1000 (ca 30%)		0,33 A	12,5 kg

POLAR CURVE

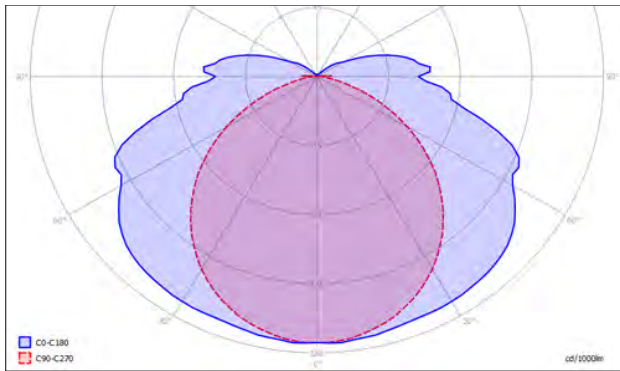

MOUNTING

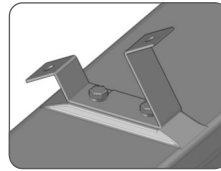

Pendant, on pipe, wall, ceiling

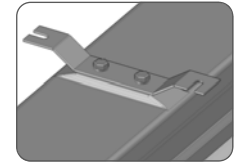
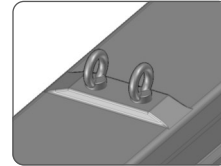
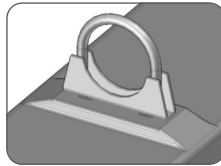

DIMENSION DRAWING [mm]

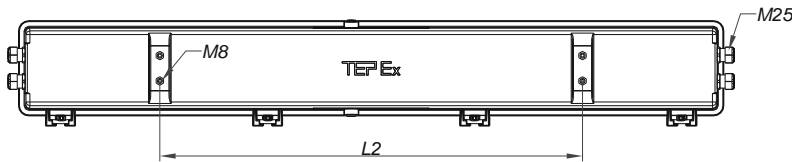
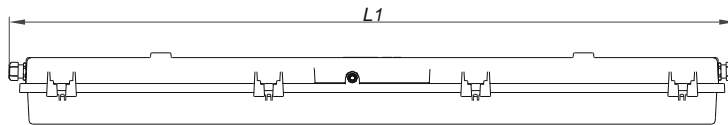
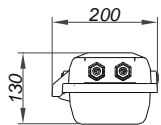

	L1 [mm]	L2 [mm]
PSF 218 E	750	400
PSF 236 E	1370	800

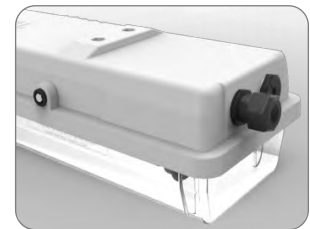

SPARE PARTS AND ACCESSORIES

SKETCH	DESCRIPTION	CODE	SKETCH	DESCRIPTION	CODE
	Diffuser PSF	PSF218 10-120 PSF236 20-120		Ex e cable gland SPU 25	SPU 25
	Gasket PSF	PSF218 10-130 PSF236 20-130		Ex e plug M25	SPC 25
	Internal reflector with lamp holder PSF	PSF218 10-140 PSF236 20-140		PSF Ceiling mounting set	PSF 30-110
	Emergency modul + battery	PSF E 20-170		PSF Pipe mounting set	PSF 30-120
	Terminals 5x2,5mm ²	PSF236 20-150		PSF Wall mounting set	PSF 30-130
	Socket key SW8	PSF236 20-160		Ring bolt M8	PSF 30-140
				PSF Pendant mounting set	PSF 30-150