



APPLICATION

The pendant light fitting type PLFS is intended for use in places with an explosive gas and dust atmosphere. The light fitting is designed for use in the industrial areas and facilities, indoor and outdoor spaces.

Hazardous zones: 1, 2, 21, 22.

CONSTRUCTION

Housing: aluminium powder painted casting

Diffuser: borosilicate glass

Accessories: protected galvanized steel gird, assembly kit for wall, pipe and ceiling mounting

TECHNICAL DATA

Certificate:	CESI 06 ATEX 052
Marking:	CE 0722
Apparatus category:	II 2GD
Marking of explosion protection:	<div style="display: flex; align-items: center;"> <div style="margin-right: 10px;">  </div> <div> II 2G Ex d e IIC T4,T5,T6 II 2D Ex tD A21 IP66 T80°C / T130°C II 2G Ex d e IIC T3/T4 </div> </div>
Ambient temperature:	-20°C ≤ Ta ≤ +40°C / +50°C - according to selection table
Degree of protection:	IP 66/67 category 1
Resistance to shock:	IK 08
Protection class :	I (protective earthing)
Rated voltage:	230 V (-10% / +6%) (other voltage on request) 12 V AC/DC, 24 V AC/DC, 110 V AC, 230 V AC-lamp type PLFS-T/FLASH
Frequency:	50Hz (60Hz on request)
Rated power:	according to table
Cable entries:	two entries Ex e M25x1,5 according EN 60423
Connecting terminals:	L1, L2, L3, N; max. 2 x 2,5 mm ² solid, flexible terminal for protective earthing conductor connection -PE; max 2x6mm ² terminal for external -PA connection; max 2x6mm ² tightening torque for screw clamp 1,2 Nm
Cable gland and plug:	II 2GD Ex e M25 IP66 tightening torque for gland screw 2,5 Nm, tightening torque for gland or plug 3,5 Nm
Cover fixing:	M 6, Hexagonal screw; without switch
Weight:	8,6 kg
Packing:	The packing contains: 2 pcs 610x390x280 mm

MOUNTING

Pendant, on pipe, wall, ceiling mounting

Allow inclination ±45° of vertical mounting



CESI 06 ATEX 052

**MODEL CODE**

MODEL CODE	WATTAGE	LAMP TYPE	LUMINOUS FLUX [lm]	LAMP HOLDER	TEMPERATURE CLASS (gas)		T ₀ MAX (dust)		
					T _a =40°C	T _a =50°C	T _a =40°C		
PLFS-T/200	max. 200 W	A	2500	E27	T4	T4	130°C		
	max. 230 W	QT	4200			T3			
	max. 160 W	LME	3150			T4			
	max. 30 W	TC-TSE	2300		T6	-	80°C		
PLFS-T/125	125 W	HME	6700		T4	-	130°C		
	110 W	HSE-I	9500			-			
PLFS-T/100	100 W	HSE	9000			-		-	-
		HIE	8400			-			
PLFS-T/70	70 W	HSE	5800		T5	T4	95°C		
		HIE	5500						
PLFS-T/150	150 W	HIE	12500	T4	-	130°C			
PLFS-T/ FLASH	15 W / 11 J (in total)	XENON	-	-	T6	-	80°C		

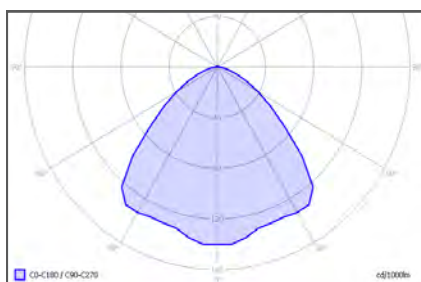
POLAR CURVE, DIMENSION DRAWING [mm]

With external reflector

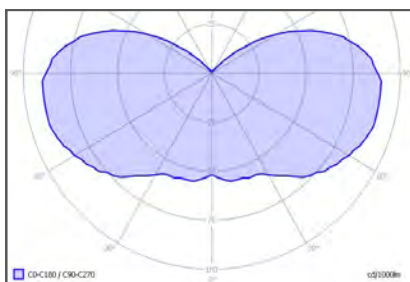

Without external reflector

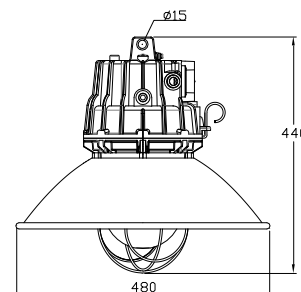
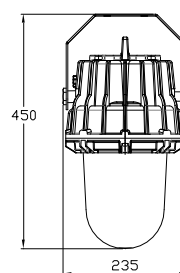
**SPARE PARTS AND ACCESSORIES**

SKETCH	DESCRIPTION	CODE	SKETCH	DESCRIPTION	CODE
	Replacement glass PLFS-T	PLFS-T 10-120		Ex e cable gland M25	SPU 25
	Wire guard PLFS-T	PLFS-T 10-130		Ex e plug M25,	SPC 25
	Base plate with lamp holder, ballast	PLFS-T 10-140		Light bulb	According to type table
	PLSF-T cover Exe set	PLFS-T 10-150		PLFS-T fixing bracket for tube R 1 1/2"	PLFS-T 20-120
	PLFS-T external reflector, wide	PLFS-T 20-100		PLFS-T mounting bracket (ceiling and wall mounting)	PLFS-T 20-130
	PLFS-T external reflector, narrow	PLFS-T 20-110			